

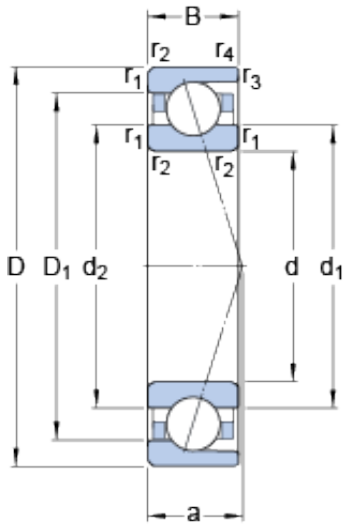

NTL BEARINGS LTD.

7214 CD/HCP4A SKF High Speed Angular Contact Ball Bearings

Bearing No. 7214 CD/HCP4A



7214 CD/HCP4A Bearing 2D drawings and 3D CAD models

Size	125x70x24 mm
Bore Diameter	125 mm
Outer Diameter	70 mm
Width	24 mm
d	70 mm
D	125 mm
B	24 mm
d ₁	87.9 mm
d ₂	87.9 mm
D ₁	107.1 mm
r _{1,2} - min.	1.5 mm
r _{3,4} - min.	0.6 mm
a	25.1 mm
d _a - min.	79 mm
d _b - min.	79 mm
D _a - max.	116 mm
D _b - max.	120.8 mm
r _a - max.	1.5 mm
r _b - max.	0.6 mm
d _n	91.6 mm
Basic dynamic load rating - C	68.9 kN
Basic static load rating - C ₀	58.5 kN
Fatigue load limit - P _u	2.4 kN
Limiting speed for grease	14000 r/min



NTL BEARINGS LTD.

Lubrication	
Limiting speed for oil lubrication	20000 mm/min
Ball - D_w	15.875 mm
Ball - z	16
G_{ref}	13.701 cm ³
Calculation factor - f_0	14.8
Preload class A - G_A	260 N
Preload class B - G_B	520 N
Preload class C - G_C	1040 N
Preload class D - G_D	2080 N
Calculation factor - f	1.08
Calculation factor - f	1
Calculation factor - f_{2A}	1
Calculation factor - f_{2B}	1.01
Calculation factor - f_{2C}	1.03
Calculation factor - f_{2D}	1.06
Calculation factor - f_{HC}	1.01
Preload class A	92 N/micron
Preload class B	124 N/micron
Preload class C	173 N/micron
Preload class D	249 N/micron
d_1	87.9 mm
d_2	87.9 mm
D_1	107.1 mm
$r_{1,2}$ min.	1.5 mm
$r_{3,4}$ min.	0.6 mm
d_a min.	79 mm
d_b min.	79 mm
D_a max.	116 mm



NTL BEARINGS LTD.

D_b max.	120.8 mm
r_a max.	1.5 mm
r_b max.	0.6 mm
d_n	91.6 mm
Basic dynamic load rating C	68.9 kN
Basic static load rating C_0	58.5 kN
Fatigue load limit P_u	2.45 kN
Attainable speed for grease lubrication	14000 r/min
Attainable speed for oil-air lubrication	20000 r/min
Ball diameter D_w	15.875 mm
Number of balls z	16
Reference grease quantity G_{ref}	13.701 cm ³
Preload class A G_A	260 N
Static axial stiffness, preload class A	92 N/ μ m
Preload class B G_B	520 N
Static axial stiffness, preload class B	124 N/ μ m
Preload class C G_C	1040 N
Static axial stiffness, preload class C	173 N/ μ m
Preload class D G_D	2080 N
Static axial stiffness, preload class D	249 N/ μ m
Calculation factor f	1.08
Calculation factor f_1	1
Calculation factor f_{2A}	1
Calculation factor f_{2B}	1.01
Calculation factor f_{2C}	1.03
Calculation factor f_{2D}	1.06
Calculation factor f_{HC}	1.01



NTL BEARINGS LTD.

Calculation factor f_0	14.8
Mass bearing	0.95 kg