

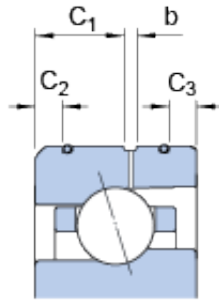

NTL BEARINGS LTD.

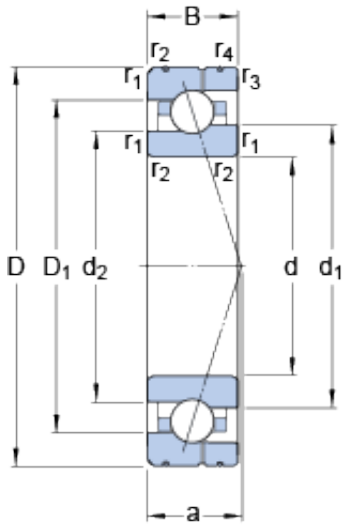

7013 CE/P4AL SKF High Speed Angular Contact Ball Bearings

Bearing No. 7013 CE/P4AL

7013 CE/P4AL Bearing 2D drawings and 3D CAD models

Size	100x65x18 mm
Bore Diameter	100 mm
Outer Diameter	65 mm
Width	18 mm
d	65 mm
D	100 mm
B	18 mm
d ₁	77.26 mm
d ₂	74.9 mm
D ₁	87.72 mm
b	1.9 mm
C ₁	9.7 mm
C ₂	3.3 mm
C ₃	3.3 mm
r _{1,2} - min.	1.1 mm
r _{3,4} - min.	0.6 mm
a	20.2 mm
d _a - min.	71 mm
d _b - min.	71 mm
D _a - max.	94 mm
D _b - max.	95.8 mm
r _a - max.	1 mm
r _b - max.	0.6 mm
d _n	79.3 mm



NTL BEARINGS LTD.

Basic dynamic load rating - C	20.3 kN
Basic static load rating - C ₀	15.6 kN
Fatigue load limit - P _u	0.655 kN
Limiting speed for grease lubrication	19000 r/min
Limiting speed for oil lubrication	30000 mm/min
Ball - D _w	8.731 mm
Ball - z	25
G _{ref}	6.2 cm ³
Calculation factor - f ₀	8.4
Preload class A - G _A	110 N
Preload class B - G _B	330 N
Preload class C - G _C	650 N
Calculation factor - f	1.09
Calculation factor - f	1
Calculation factor - f _{2A}	1
Calculation factor - f _{2B}	1.03
Calculation factor - f _{2C}	1.05
Calculation factor - f _{HC}	1
Preload class A	53 N/micron
Preload class B	83 N/micron
Preload class C	112 N/micron
d ₁	77.26 mm
d ₂	74.9 mm
D ₁	87.72 mm
C ₁	9.7 mm
C ₂	3.3 mm
C ₃	3.3 mm
r _{1,2} min.	1.1 mm



NTL BEARINGS LTD.

$r_{3,4}$ min.	0.6 mm
d_a min.	71 mm
d_b min.	71 mm
D_a max.	94 mm
D_b max.	95.8 mm
r_a max.	1 mm
r_b max.	0.6 mm
d_n	79.3 mm
Basic dynamic load rating C	20.3 kN
Basic static load rating C_0	15.6 kN
Fatigue load limit P_u	0.655 kN
Attainable speed for grease lubrication	19000 r/min
Attainable speed for oil-air lubrication	30000 r/min
Ball diameter D_w	8.731 mm
Number of balls z	25
Reference grease quantity G_{ref}	6.2 cm ³
Preload class A G_A	110 N
Static axial stiffness, preload class A	53 N/ μ m
Preload class B G_B	330 N
Static axial stiffness, preload class B	83 N/ μ m
Preload class C G_C	650 N
Static axial stiffness, preload class C	112 N/ μ m
Calculation factor f	1.09
Calculation factor f_1	1
Calculation factor f_{2A}	1
Calculation factor f_{2B}	1.03
Calculation factor f_{2C}	1.05
Calculation factor f_{HC}	1



NTL BEARINGS LTD.

Calculation factor f_0	8.4
Mass bearing	0.43 kg