

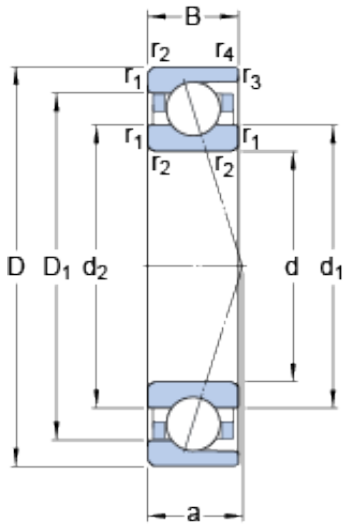

NTL BEARINGS LTD.

71912 CD/HCP4A SKF High Speed Angular Contact Ball Bearings

Bearing No. 71912 CD/HCP4A



71912 CD/HCP4A Bearing 2D drawings and 3D CAD models

Size	85x60x13 mm
Bore Diameter	85 mm
Outer Diameter	60 mm
Width	13 mm
d	60 mm
D	85 mm
B	13 mm
d ₁	67.7 mm
d ₂	67.7 mm
D ₁	77.3 mm
r _{1,2} - min.	1 mm
r _{3,4} - min.	0.3 mm
a	16.3 mm
d _a - min.	64.6 mm
d _b - min.	64.6 mm
D _a - max.	80.4 mm
D _b - max.	83 mm
r _a - max.	1 mm
r _b - max.	0.3 mm
d _n	69.7 mm
Basic dynamic load rating - C	19.9 kN
Basic static load rating - C ₀	15.3 kN
Fatigue load limit - P _u	0.655 kN
Limiting speed for grease	18000 r/min



NTL BEARINGS LTD.

Lubrication	
Limiting speed for oil lubrication	28000 mm/min
Ball - D_w	7.938 mm
Ball - z	24
G_{ref}	2.7 cm ³
Calculation factor - f_0	10.5
Preload class A - G_A	70 N
Preload class B - G_B	140 N
Preload class C - G_C	280 N
Preload class D - G_D	560 N
Calculation factor - f	1.17
Calculation factor - f	1
Calculation factor - f_{2A}	1
Calculation factor - f_{2B}	1.07
Calculation factor - f_{2C}	1.12
Calculation factor - f_{2D}	1.18
Calculation factor - f_{HC}	1.04
Preload class A	56 N/micron
Preload class B	74 N/micron
Preload class C	102 N/micron
Preload class D	145 N/micron
d_1	67.7 mm
d_2	67.7 mm
D_1	77.3 mm
$r_{1,2}$ min.	1 mm
$r_{3,4}$ min.	0.3 mm
d_a min.	64.6 mm
d_b min.	64.6 mm
D_a max.	80.4 mm



NTL BEARINGS LTD.

D_b max.	83 mm
r_a max.	1 mm
r_b max.	0.3 mm
d_n	69.7 mm
Basic dynamic load rating C	19.9 kN
Basic static load rating C_0	15.3 kN
Fatigue load limit P_u	0.655 kN
Attainable speed for grease lubrication	18000 r/min
Attainable speed for oil-air lubrication	28000 r/min
Ball diameter D_w	7.938 mm
Number of balls z	24
Reference grease quantity G_{ref}	2.7 cm ³
Preload class A G_A	70 N
Static axial stiffness, preload class A	56 N/ μ m
Preload class B G_B	140 N
Static axial stiffness, preload class B	74 N/ μ m
Preload class C G_C	280 N
Static axial stiffness, preload class C	102 N/ μ m
Preload class D G_D	560 N
Static axial stiffness, preload class D	145 N/ μ m
Calculation factor f	1.17
Calculation factor f_1	1
Calculation factor f_{2A}	1
Calculation factor f_{2B}	1.07
Calculation factor f_{2C}	1.12
Calculation factor f_{2D}	1.18
Calculation factor f_{HC}	1.04



NTL BEARINGS LTD.

Calculation factor f_0	10.5
Mass bearing	0.16 kg